

[www.cs-france.fr](http://www.cs-france.fr)

# COUVRANEUF®

ALUMINIUM FLOOR FLUSH HEAVY DUTY

APF Series



France



# Aluminium Floor Flush Heavy Duty

Covers 25 to 150 mm

APF Series

### Product description:

An all-metal system made of aluminium alloy profiles, highly resistant to rolling loads, distortion and wear. Maintains a virtually flush finish ideal for heavy rolling equipment.

### Use This Cover For:

Applications with heavy rolling loads such as:

- Fork lifts with full or pneumatic tires, of a permissible total weight equal to 70 kN (tire adhesion area 20 cm x 20 cm)
- Trucks with pneumatic tires, of a permissible total weight equal to 300 kN
- Vehicles and goods handling trucks with tires of hard plastics. The permissible load, depending on a tire width, is 6,5 kg per every mm of a tire width.

### Performance Characteristics:

The unique interlocking cover design allows for significant horizontal movement in the floor slab, as well as some vertical deflection, and is designed to withstand heavy and frequent rolling loads. By comparison, conventional cover plates utilizing turnbars are prone to failure when subjected to rolling loads over any length of time due to fatigue in the moving parts. This system is also ideal for areas where significant foot traffic is expected such as malls and airports and is considered extremely low maintenance. The interlocking cover assembly utilizes precision gaskets to eliminate any metal-to-metal noise and to prevent the infiltration of liquids.

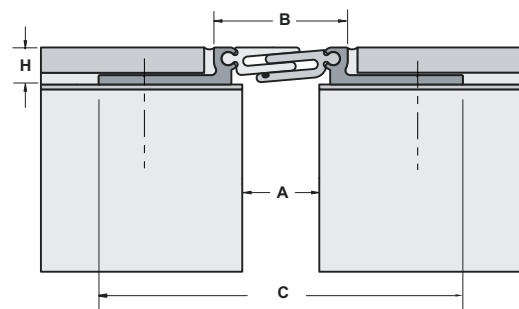

APF 25-15



MODEL	Joint width	Overall product	Exposed	Overall	Movement	
	A ( mm )	height H ( mm )	surfaced B ( mm )	product width C ( mm )	in mm	
APF 25-15	25	15	53	138	+ 5 / - 5	+ 5 / - 5
APF 50-25	50	25	77	199	+ 10 / - 10	+ 13 / - 15
APF 50-50	50	50	77	199	+ 10 / - 10	+ 13 / - 15
APF 50-75	50	75	77	199	+ 10 / - 10	+ 13 / - 15
APF 75-25	75	25	110	232	+ 15 / - 15	+ 21 / - 21
APF 75-50	75	50	110	232	+ 15 / - 15	+ 21 / - 21
APF 75-75	75	75	110	232	+ 15 / - 15	+ 21 / - 21
APF 100-25	100	25	134	256	+ 20 / - 20	+ 23 / - 30
APF 100-50	100	50	134	256	+ 20 / - 20	+ 23 / - 30
APF 100-75	100	75	134	256	+ 20 / - 20	+ 23 / - 30
APF 150-38	150	38	185	325	+ 30 / - 30	+ 16 / - 17
APF 150-75	150	75	185	325	+ 30 / - 30	+ 16 / - 17

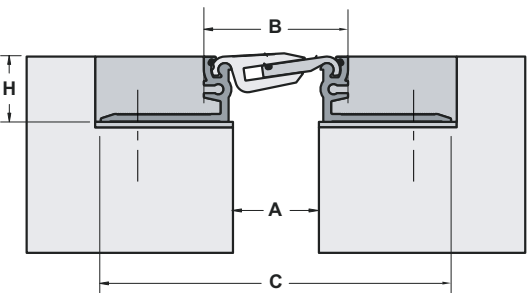

APF - Floor to floor

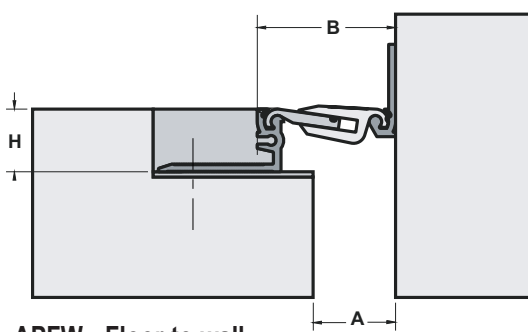

APFW - Floor to wall

### Standard Finishes:

This system is available in mill finish. The APF models are supplied factory pre-assembled in standard lengths of 3 m. Specific floor transitions to allow the continuity of the expansion joint covers are factory manufactured as T, L and X sections.

### Installation Guidelines:

A set of installation instructions are systematically supplied together with the materials to the installation company. The blockouts must be prepared to receive the joint cover. It is recommended the cover be leveled on a high strength, non-shrink epoxy bed. The cover assembly is delivered in a fixed position/width through the use of shipping straps engineered for the specific movement criteria of the project. Center the assembly over the joint opening and fasten in place with supplied mechanical fasteners. Remove shipping strap after attachment. Fill blockout area with nonshrink grout and apply floor finish as required.



### Typical project applications:

- Small, medium and large all time open shopping centers
- Covered galeria and shopping malls
- Airport terminals
- Train stations
- Sport arenas
- Storage areas
- Industrial facilities
- multi-use facilities, etc ...





# couvraneuf® APF Series

typical project applications

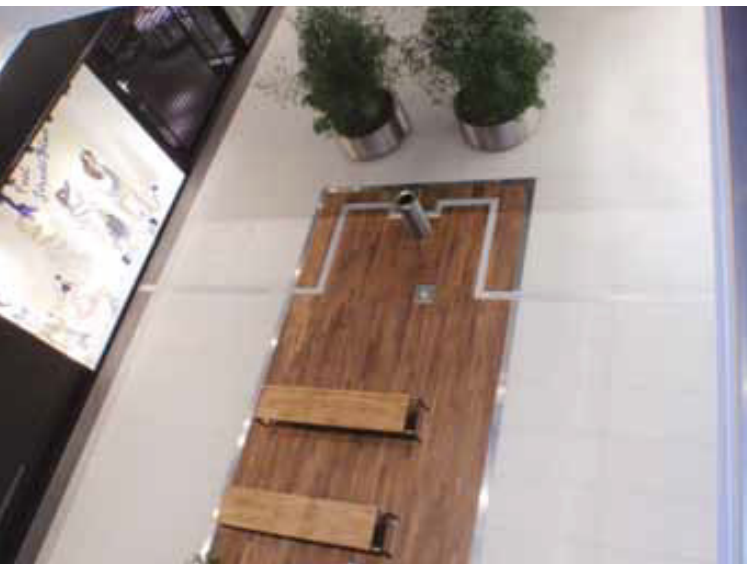

Storage areas, **Industrial facilities**, shopping malls, **airports**, railway stations, **sport stadiums**, exhibition and conference centres, **bus terminals**, multi-use facilities, etc.



**France**

**C/S France Sarl**  
**135, rue Edouard Isambard - B.P. 66**  
**27120 Pacy-sur-Eure Cedex**  
**FRANCE**

Tel. : 00 33 (0)2 32 67 00 00

Fax : 00 33 (0)2 32 67 14 12

Site internet : [www.cs-france.fr](http://www.cs-france.fr)

E-mail : [marketing-export@cs-france.fr](mailto:marketing-export@cs-france.fr)

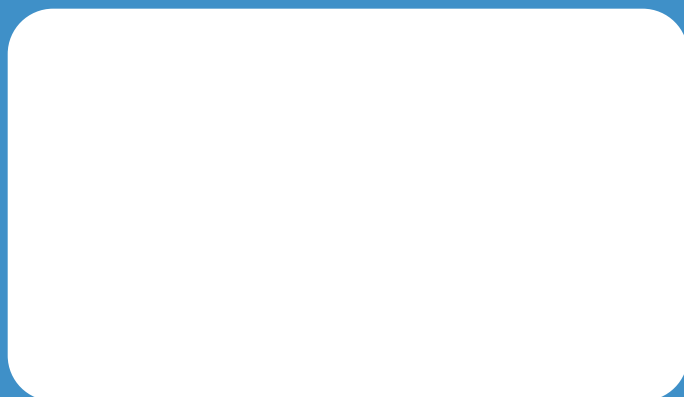

Architectural Solutions



**Construction Specialties**

WORLDWIDE

COUVRANEUF



Expansion joint  
covers systems

C/S ACROVYN®



Wall, corner and  
door protection

C/S PEDISYSTEMS



Entrance flooring  
systems

WATTOHM



Technical profiles and  
plastic tubes

WATTOLENE



Extruded polystyrene  
sheets

LUMISYSTEMS



Lighting appliances

C/S AIRFOIL



Sun controls